

WAD NEWS

The Newsletter of the Woodcrafters Association of Durban

Issue 20

August / September 2006

In This Issue

- CHAIRMAN'S TURN -
- RECENT EVENTS
- WOOD OF THE MONTH
- WEB REVIEW
- TIPS & TECHNIQUES
- WHAT'S HAPPENING



Wynand Van der Merwe
Clock in African Rosewood



Jonathan Fabian
Artists Easel in Imbuia & Maple

Next Meeting

Bring a plane iron, chisel and/or scraper

A hands-on sharpening workshop is the agenda for the meeting on 14/08. I encourage you to bring along one of the above tools that need sharpening. The emphasis will be on YOU to do the sharpening. The instructors will be there to show and guide you.

If you bring a plane iron bring the plane as well. You need to try it out



Neil Knight
Fireplace and Mantelpiece in Black Walnut



Chairman

Perrie bullock
pbullock@intekom.co.za
 7657403(H) 0824427114

Treasurer

Albert Paterson
 7673338

Secretary

John Morgan
 7027679

Librarian

Geoff Etheridge

Members

Rod Ball

Neil Knight

Tom Holden

Derek Williamson

Membership

Application forms are available at the monthly meetings from the treasurer, Albert Patterson.

Joining Fee:	R200.0
Annual Subscription:	
Normal	R140.0
Pensioners	R90.00
Woodturning Section	
In addition to the fees above:	R70.00

Visitors:

It was a pleasure to entertain the following visitors who joined us at our last meetings. I trust that you enjoyed the demonstration and we hope to see you again shortly.

Ian Sarveseh, Terry Estment, Paul Hoepel, Harold Joe, Trevor Varty and Forbes Horncastle

CHAIRMAN'S TURN

Perrie Bullock

With the Baynesfield Museum Public Exhibition outing coming up at the end of the month (30th July), it is appropriate to reflect on the effort that Ken and his team have put into this venture. Ken has developed the restoration and preservation of woodworking tools and equipment to the point where it now occupies about 10 rooms of the original old Baynesfield homestead. It is fortunate that there is space enough to enable each room to be dedicated to a specific discipline eg wagon wheels, turning, restoration etc. Baynesfield Estate continues to operate as a functional farm, while the old restored butter factory serves as the centre for Vintage Tractor & Stationary Machine Club, which is active in resuscitating tractors, steam and other engines. To this end, they are doing a great service to the community in reminding the public of yester-years' activities. Members of both branches enjoy hospitality and great camaraderie when they get together in their efforts to restore elements of the past. It is a great tribute to Ken and his team to participate in the woodworking arena and to maintain an interest in the history of this field of endeavour. It is most complimentary to the whole theme of this venue. While it is still very much in its infancy, it is attracting much public interest. This is perhaps quite understandable, given that the Estate is located in such a beautiful area of Kwa-Zulu Natal and is maintained in such a disciplined manor. It forms part of a local conservancy and is therefore likely to continue to enjoy this status into the future. The venue encourages the public to attend quarterly functions where children can enjoy open spaces while adults look over the efforts of the restorers. Light refreshments are available on public open days.

For those of you who have not yet had an opportunity of visiting the centre, let me encourage you to do so. More importantly, if you are able to offer assistance to Ken and his team on the 29th July in preparing for the next day's public event, please advise him accordingly.

The month of July is a busy one for club members, for apart from Baynesfield, there is the preparation for the Durban HOBBY-X Exhibition from 3rd to 6th August underway. I am pleased to record my thanks to the many members who have offered their participation in this event. I will be contacting you with details of the roster as to when and where your services will be required. I believe that we can look forward to this event with enthusiasm and trust that it may also encourage new members to join our organisation. In this connection, there appears to be some reticence on the part of "new-comer" woodworkers to join W A D because they are "not sufficiently skilled"! I have of course, used my best endeavours to dispel this notion and I encourage members to do the same when they come across these expressions. Indeed the very opposite should prevail, namely that new members join to learn and improve their skills by gaining knowledge and experience from those who have already improved their abilities as a consequence of being a member of W A D. I hope we can encourage new members to replace those who have recently left, mostly as a consequence of re-locating.

Enjoy your woodworking

Perrie

RECENT EVENTS

July 30

Baynesfield

Baynesfield country Estate situated in the Natal Midlands is the legacy of a most remarkable man, Joseph Baynes. Baynes was a pioneer in the dairy and farming industry in Southern Africa and on his death, left his entire estate as a gift to the people of South Africa, so that it may in the future become a centre of industry, education and beauty for the public benefit and the benefit of South Africa. An area of the estate has been declared a museum and to this effect has been developed to remind us of past crafts, skills and industries of which Perrie has mentioned in the Chairman's Turn.



The next open day is being held on **3rd December** at Baynesfield Estate. It is a great day out for the whole family. So come along and enjoy yourself

WEB REVIEWS

By Charles Thatcher

Name:- Dennis Laidler

Link: <http://www.lando.co.za/dlaidler/default.htm>

It is great to feature a local site for a change. Dennis Laidler, a member of the Western Cape Woodturners Association has developed a great site which is well laid out, easy to navigate and with quick upload times. Start in the gallery where Dennis's unique turnings will leave you inspired. The links page will help you find local and international suppliers as well as guiding you to other wood artists both local and international. Make sure you've got a couple of hours to spare and enjoy the ride.

Name:- Wood Artists / Turners / furniture makers

Link: <http://www.nwfinewoodworking.com/index.html>
<http://www.ironwoodgallery.com/>
<http://www.electroniccottage.com/wood.html>
[http://www.sausalitoartgalleries.com/Art%20Categories/artists and art categories.htm](http://www.sausalitoartgalleries.com/Art%20Categories/artists%20and%20art%20categories.htm)
[http://lineartgallery.com.hosting.domaindirect.com/web/Artist/Lohman/wood art furniture/index.htm](http://lineartgallery.com.hosting.domaindirect.com/web/Artist/Lohman/wood%20art%20furniture/index.htm)
<http://artseek.com/medias/WOOD/index.html>

Looking for inspiration, reference or ideas? Try these artists and galleries and you will not be disappointed. Obviously I am assuming you have nothing to do and have time to surf all day, it will take a while!

TIPS & TECHNIQUES

Recently at the Hobby Ex show I was template routing different shaped breadboards on a router table and had several near mishaps when starting the cut, a starting pin as detailed below is a method of preventing this

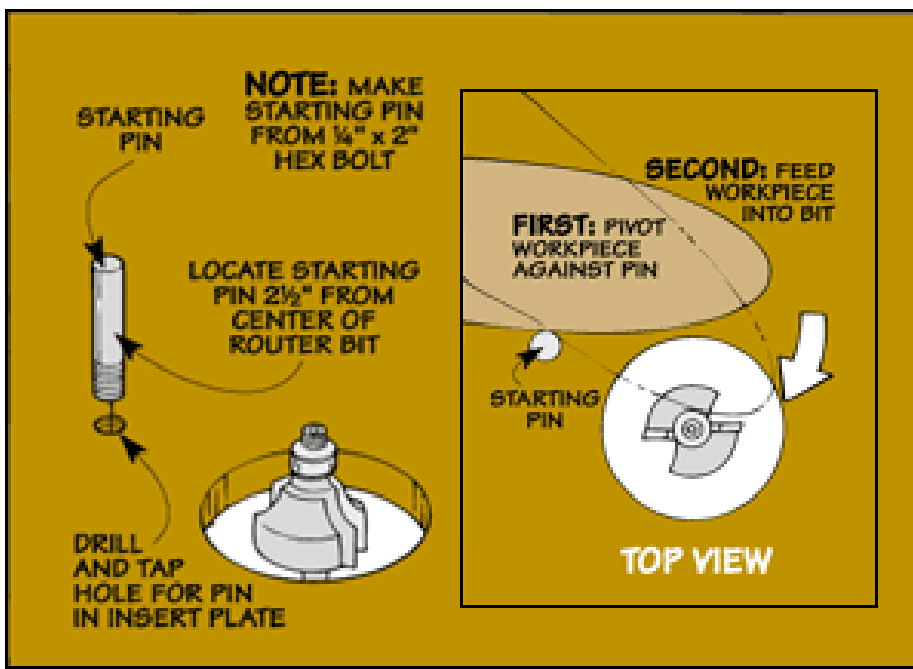

If you're using a piloted bit to rout an irregular-shaped workpiece, the beginning of a cut can be a bit tricky. That's because the bit has a tendency to grab the workpiece.

To reduce the chance of that happening, I use a starting pin. This is just a cutoff bolt that threads into a hole in the insert plate.

It's easy to use a starting pin. Simply pivot the workpiece against the pin as you feed it into the bit. The pin provides the leverage needed to make a controlled cut.

WOOD OF THE MONTH

By Charles Thatcher

Jacaranda *Jacaranda Mimosifolia*

Other Names: Blue Trumpet Tree, Fern Tree, Green Ebony

Tree: The Jacaranda tree is indigenous to South America and is a fast growing deciduous tree, with soft graceful fern-like foliage forming a rounded crown. It thrives in fertile, well-drained sunny areas. The tree puts on a breathtaking floral display. Its vivid lilac-blue clusters of trumpet-shaped blossoms appear in the spring, later falling to the earth carpeting the ground with a mass of color. There are many conflicting stories about how it originally ended up in South Africa but it is generally believed that the first seed was imported from Argentina by a Mr James Clarke and the first trees were planted in Pretoria in 1906.

The Jacaranda has recently been named an 'alien invasive plant' as it is believed that they incur on indigenous plant populations

Common Uses: Mainly used as an ornamental tree. Commercially Jacaranda is not extensively used, but amongst specialist cabinet makers it is used in the making of fine furniture and carcass work. Jacaranda is probably the most common wood used by Woodturners in South Africa as it is readily available and easy to turn.

Wood: Heartwood is a rich honey colour. That is close grained and often very figured. A beautiful wood for both turning and cabinet making.

Durability: A relatively soft wood that is durable indoors. Unless treated correctly, can be susceptible to wood borer and fungus marking (bluing) during drying. A very stable timber with very little wood movement, which makes it ideal for carcass work.

Workability: Machines very easily with both machine tools and hand tools. Easy to sand and comes up beautifully under most finishes.



WHAT'S HAPPENING

Please let me know of any events that would be of interest to our members, I need to know when and where and I will endeavor to include it in the next newsletter.

WAD
MEETINGS

AUGUST 14TH

18h00

WOODCRAFT

Long Island Woodwork Show & Hand Tool Sharpening

**Charles Thatcher
Neil Knight &
Jonathan Fabian**

A look at the exhibits at this show in New York, followed by a hands-on, plane, chisel and scraper sharpening demo. Bring along your planes or scrapers and give it a go.

AUGUST 21ST

18h00

WOODTURNING

Sharpening Turning Tools

Carrying on the theme of sharpening for the month, in this instance it will be turning tools.

SEPTEMBER 11TH

18h00

WOODCRAFT

Video Evening, Tools, Tips & Techniques

.The Association has some very good DVD's and Videos form which a lot can be learned.

SEPTEMBER 18TH

18h00

WOODTURNING

To Be Advised

**MARCUS KRUGER
WOODWORKING COURSES**

19 Aug - Basic Carcass Construction
26 Aug - Chair making

There is still space on both these courses.
Tel. 031 2616465

**Ken Tebbut's
Woodworking Classes**

Learn Woodworking with Ken a retired
woodworking instructor

Tel. 031 7023697

THE CLASSIFIEDS

OFFERED FOR FREE

BOWL LATHE WITH CHUCK

This very sturdy homemade lathe used by an experienced turner for many years is offered free of charge to a deserving home

Contact: Mike Chapman 031 7644238